

# DM-FS Flush mount Shovel and Trax Holder

## INSTRUCTIONS



### Thank you for purchasing our DM-FS Bracket Kit

This kit is designed to mount your MAXTRAX MkII/XTREME or TRED GT/HD/Pro recovery tracks plus a shovel, axe or other long-handled tool to your DASH Roof Rack.

All supplied components are made from durable 300-series stainless steel, and the brackets themselves from 5mm aluminium plate to ensure the product's longevity.

If you have any questions regarding your installation that aren't addressed in this manual, please get in touch with us at [Sales@dashoffroad.com.au](mailto:Sales@dashoffroad.com.au)

### Kit Contents:

- 1) 2x DM-FS Brackets (*1x Left, 1x Right*)
- 2) 4x M6 Countersunk Screws
- 3) 2x M6 Button Head Screws
- 4) 2x M6 Flat Washers
- 5) 2x M6 Nyloc Nuts
- 6) 6x M8 Channel Nuts
- 7) 4x 3mm Spacer
- 8) 6x M8 Button Head Screws
- 9) 6x M8 Spring Washer
- 10) 6x M8 Flat Washer

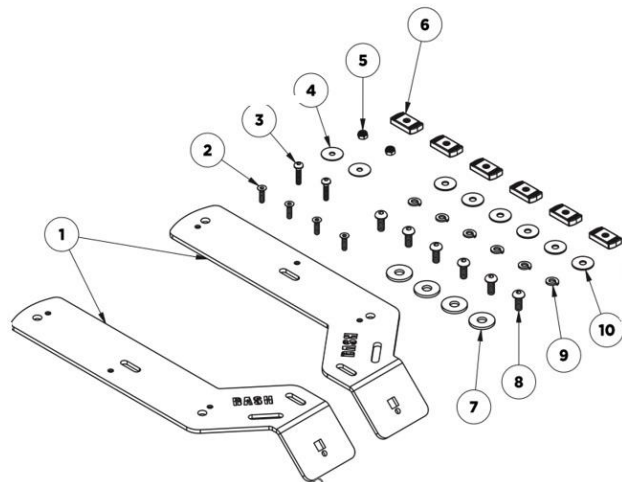

# DM-FS Flush mount Shovel and Trax Holder

## INSTRUCTIONS



- 1) Fix **MAXTRAX** or **TRED** Mounting Pins (not included) to **MT-FS Brackets** (1)

### For TRED Pins

Install using **M6 Countersunk Screws** (2) from this kit, with **Rubber Spacers** from pin kit

*Optional: Use threadlocker (not included) on countersunk screw to ensure they don't work loose over time*

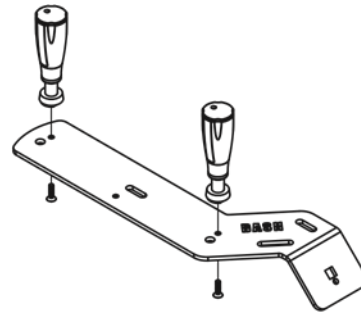

### For MAXTRAX Pins

Install using **M10 Washers** and **Nyloc Nuts** from the pin kit, ensuring pins are oriented as shown

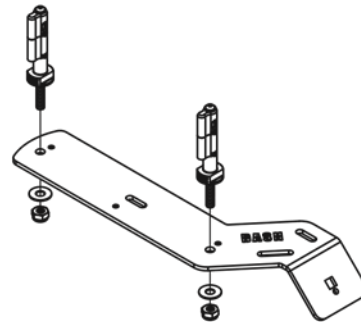

- 2) Fix **Yakima AceO'Spades** or **Rhino Rack Stow It** shovel holders (not included) to both brackets using **M6 Button Head Screws** (3), **Flat Washers** (4), and **Nyloc Nuts** (5)

*Note: Use round hole for AceO'Spades  
Use square hole for Stow It*



- 3) For each bracket, locate two **Channel Nuts** (6) in your platform's outer rails, and one in the first inner rail.

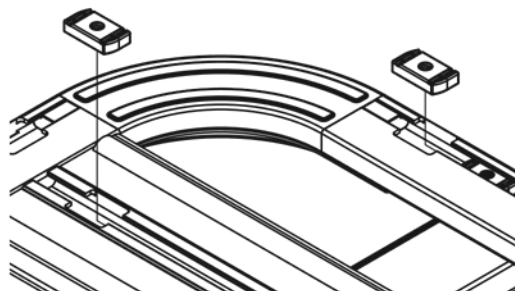

# DM-FS Flush mount Shovel and Trax Holder

## INSTRUCTIONS



- 4) Place the four **3mm Spacers (7)** on top of the outer rail above each **Channel Nut**

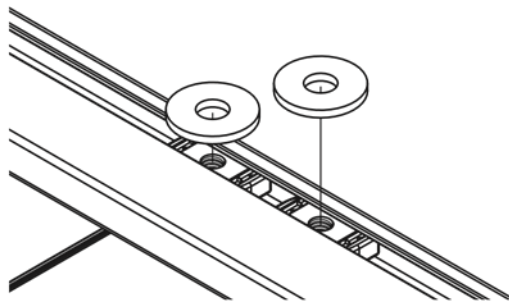

- 5) Place assembled brackets on your platform with pins 890mm apart, securing to channel nuts using **M8 Screws (8)**, **Spring Washers (9)**, and **Flat Washers (10)**, ensuring they are fully tightened

*Optional: Use your recovery tracks to check bracket spacing before fully tightening*

*Notes: All fasteners and washers **must** be used and firmly tightened*

