

# DA-AM ANTENNA MOUNT INSTRUCTIONS



## Thank you for purchasing our DA-AM Antenna Mount

This kit is designed to mount to your DASH Offroad Platform and mounting a fold away antenna mount. Giving you easy access to everything else on your platform.

The mount and all supplied components are made from durable 300-series stainless steel to ensure the longevity of the product.

If you have any questions regarding your install that aren't addressed in this manual, please contact us at [dashoffroad.com.au](http://dashoffroad.com.au)

### Kit Contents:

- 1x DA-AM Antenna Mount
- 2x M8x20 Button Head Screws
- 2x M8 Spring Washer
- 2x M8 Flat Washer
- 2x M8 Channel Nuts

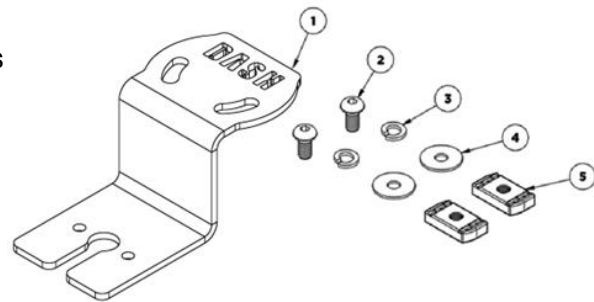

### Installation Instructions:

**1) Locate Channel Nuts** in your platform in desired location.

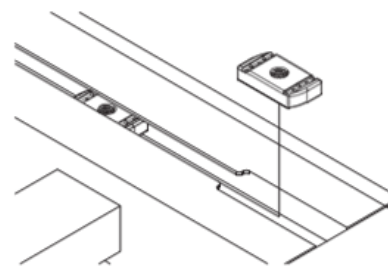

**2) Place DA-AM Antenna Mount (1)** on your platform, securing to channel nuts using **M8 Screws (2), Spring and Flat Washers (3 & 4)**, ensuring they are fully tightened

*Notes: All fasteners and washers must be used and firmly tightened*

